

Service tips



Service tips

We would like to give you some additional information so that you can continue to enjoy your new Bruynzeel kitchen for as long as possible. Please read through the tips shown below carefully to ensure optimum use of your kitchen.

User tips

Once your kitchen has been installed, check the threaded ring on the sink waste outlet a few times and tighten if necessary. This will prevent any unwanted leakage.

Never leave the door of an oven, combi-microwave or dishwasher open after use. This will help prevent any damage to the doors and cabinets caused by heat or moisture.

Always use a chopping board for cutting meat, vegetables, etc. This is more hygienic and will prevent irreparable scratches/damage to the work surface.

Do not drag heavy objects such as beer crates and shopping baskets over the work surface. This will prevent irreparable scratches.

Never place a hot pan directly on the work surface. If you do, the surface may discolour or even crack.

Always switch on the extractor hood when using the cooktop, even when just boiling a pan of water. And never place coffee machines and kettles directly below the upper cabinets. Steam can cause moisture damage to the cabinet next to it or immediately above.

Do not allow water to remain unnecessarily on surfaces – always wipe off everything with a dry cloth.

Remember that stainless steel sinks can be scratched easily if heavy and sharp objects are placed in them.

Maintenance/care tips

- Use a soft cloth and lukewarm water and a little washing up liquid for your daily cleaning of the kitchen cabinets and work surface.
- Never use scourer-sponges. They leave scratches.
- Never use corrosive cleaning products.
- You can disguise minor scratches in an artificial work surface using furniture oil or HG plastic quick gloss.
- Use Staalfix to make small scratches in the sink less visible.

For more information, see the instructions for use and maintenance tips in the sales agreement – or take a look at our website at bruynzeelkeukens.nl, YouTube or the website of the supplier of your work surface, accessories or equipment.

Service tips



Adjusting the cabinet fronts

As you use your kitchen, you may find that the cabinet fronts (doors) do not hang entirely straight over the course of time. The good thing is, you can easily adjust the cabinets yourself. Start by removing the cover from the hinge unit (if there is one) so that you can see the screws, as shown in the pictures below.

1. To raise or lower the cabinet front: loosen all of the hinges by undoing the screws, as illustrated. You can then adjust the front up or down and tighten the screws again.

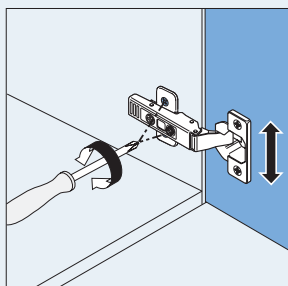

2. To move the fronts slightly to the left or right, tighten or loosen the hinge screw at the front.

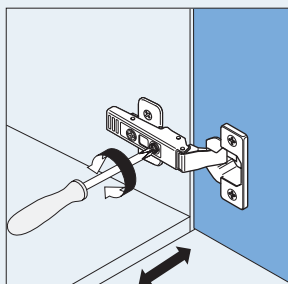

3. To adjust the fronts to make them closer to the cabinet, tighten or loosen the hinge screw at the back.

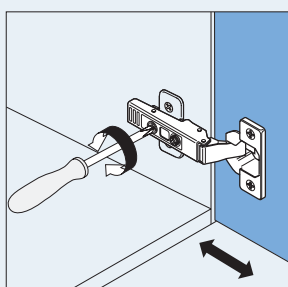

If the sliding door guides on the fridge don't run smoothly or makes a noise, we advise you to apply some silicon spray.

Adjusting the cabinet fronts drawers does not come under the warranty. If you would like to make an appointment with a service technician from Bruynzeel Kitchens, you can contact us at any time via our website: www.bruynzeelkeukens.nl/service-garantie.